

**munchkin.**

98° Digital Bottle Warmer

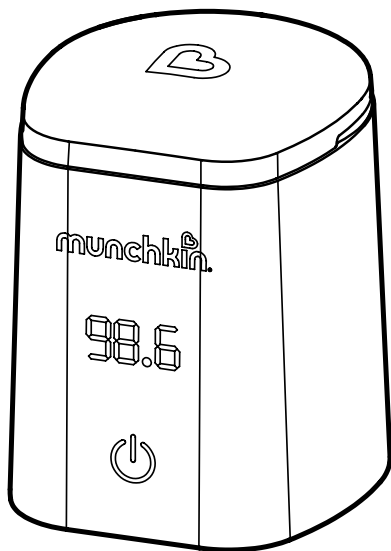

---

KEEP FOR FUTURE REFERENCE

Please read the instructions carefully before using this product.

<b>! IMPORTANT SAFEGUARDS</b>	
FCC Information .....	3
<b>⚙️ INCLUDED PARTS</b>	
Included Parts.....	6
Included Adapters.....	7
<b>👉 HOW TO USE</b>	
Maintenance and Cleaning.....	8
One-Year Limited Warranty.....	11
Technical Specifications.....	11
<b>💬 CUSTOMER SERVICE</b>	
Contact Us .....	11

# IMPORTANT SAFEGUARDS

## **! WARNING: Strangulation hazard! Keep out of reach of children. Do not use with extension cords.**

When using electrical appliances, basic safety precautions should always be followed, including the following:

- Read all instructions carefully before using your digital bottle warmer.
- To protect against electrical shock, do not immerse the appliance, cord or plug in water or any liquid. Clean with damp cloth only. Avoid spillage on the connector.
- For use by adults for intended purposes only. Any other use is inappropriate and dangerous. Keep out of the reach of children.
- Appliance should be placed on a flat and stable area away from hot surfaces.
- Do not let cord hang over edge of table or counter or touch a hot surface.
- Do not move appliance when in use or if it contains hot water or liquid.
- The warming chamber may become hot. Do not touch while in use and let cool before handling.
- Ensure the baby bottle contents are at a safe temperature before feeding.
- Use plastic baby bottles approved for boiling or glass thermo-resistant baby bottles with this appliance.
- Do not use this product to heat frozen baby bottles.
- Unplug from outlet when not in use and before cleaning. Allow to cool before putting on or taking off parts and before cleaning. Allow warmer to cool before cleaning.
- Do not operate any appliance with a damaged cord or plug after the appliance malfunctions or has been damaged in any manner. Return appliance to Munchkin, Inc. for examination, repair, or adjustment.
- The use of accessory attachments is not recommended by the appliance manufacturer and may cause injuries.
- Do not place on or near a hot gas or electric burner, or in a heated oven.
- Always attach plug to appliance first, then plug cord into the wall outlet. To disconnect, turn any control to "off" then remove plug from wall outlet.
- To disconnect, always make sure unit is "off" before removing plug from wall outlet.
- Do not use appliance for other than intended use.
- Before serving the contents, unplug cord from wall outlet. Do not leave cord within child's reach.
- Close supervision is necessary when any appliance is used by or near children.
- Extreme caution must be used when moving an appliance containing hot liquids.

- This appliance is not intended for use by persons (including children) with reduced physical, sensory or mental capabilities, or lack of experience and knowledge, unless they have been given supervision or instruction concerning use of the appliance by a person responsible for their safety. Children should be supervised to ensure that they do not play with the appliance.
- A short power-supply cord (or detachable power-supply cord) should be used to reduce the risk resulting from becoming entangled in or tripping over a longer cord. Longer detachable power-supply cords or extension cords are available and may be used if care is exercised in their use. If a longer detachable power-supply cord or extension cord is used:
  - a. The marked electrical rating of the cord set or extension cord should be at least as great as the electrical rating of the appliance.
  - b. The cord should be arranged so that it will not drape over the countertop or tabletop where it can be pulled on by children or tripped over unintentionally.
  - c. If the appliance is of the grounded type, the cord set or extension cord should be grounding- type 3-wire cord.
- To be used with baby bottles only. May cause serious injury if used with any other vessel.
- The heating element surface is subject to residual heat after use.
- For household use only. Do not use outdoors.
- Do not touch hot surface.

## SAVE THESE INSTRUCTIONS

**NOTE:** These instructions are to be used as a guide only. Please note that there are many variables, such as size of the baby bottle, ambient temperature, and starting temperature of the liquid, which can impact the speed as well as the final temperature at which this unit warms the liquid. Adjustments to the instructions below may be necessary. Always test temperature of the liquid with a thermometer before feeding baby. The food should not be heated for an extended amount of time.

## FCC WARNING

This device complies with part 15 of the FCC Rules. Operation is subject to the following two conditions: (1) This device may not cause harmful interference, and (2) This device must accept any interference received, including interference that may cause undesired operation.

**! WARNING:** Changes or modifications to this unit not expressly approved by the party responsible for compliance could void the user's authority to operate the equipment.

**NOTE:** This equipment has been tested and found to comply with the limits for a Class B digital device, pursuant to part 15 of the FCC Rules. These limits are designed to provide reasonable protection against harmful interference in a residential installation. This equipment generates, uses and can radiate radio frequency energy and if not installed and used in accordance with the instructions, may cause harmful interference to radio communications. However, there is no guarantee that interference will not occur in a particular installation. If this equipment does cause harmful interference to radio or television reception, which can be determined by turning the equipment off and on, the user is encouraged to try to connect the interference by one or more of the following measures:

- Reorient or relocate the receiving antenna.
- Increase the separation between the equipment and receiver.
- Connect the equipment into an outlet on a circuit different from that to which the receiver is connected.
- Consult the dealer or an experienced radio/TV technician for help.

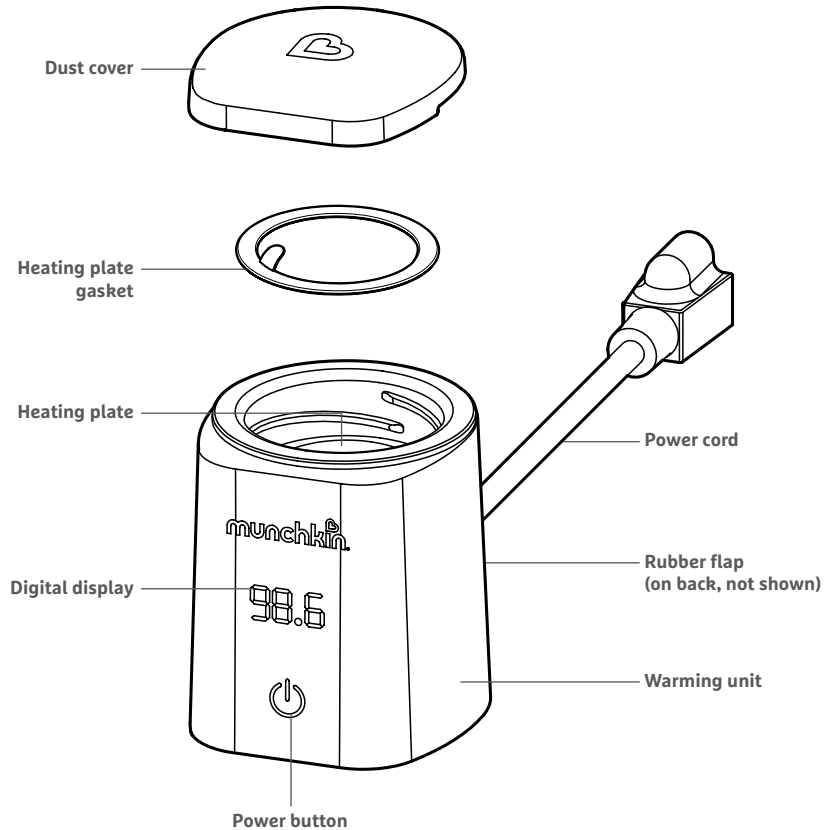

**No adapter necessary for:**

- Avent Natural 4oz and 9oz\*
- EvenFlo Balance 5oz and 9oz\*

**Adapter A (with Gasket) for:**

- Dr. Brown's 4oz and 8oz\*
- Medela 5oz and 8oz\*
- Nuk First Essentials 5oz and 9oz\*
- EvenFlo Feeding Classic 4oz and 8oz\*
- Parents Choice 5oz and 9oz\*

**Adapter B (with Gasket) for:**

- Tommee Tippee 5oz and 9oz\*

**Adapter C (with Gasket) for:**

- Nuk Simply Natural 5oz and 9oz\*

**Adapter G (with Gasket) for:**

- Comotomo 5oz and 8oz\*
- Olababy 4oz and 8oz\*
- Boon Nursh 4oz and 8oz\*

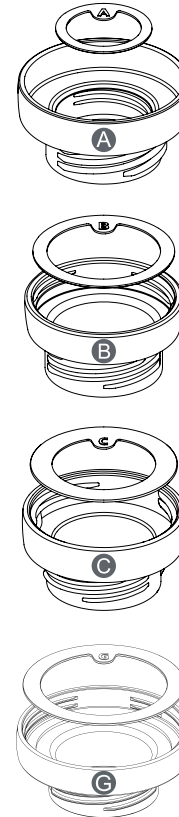

**⚠️ WARNING: Do not use glass baby bottle without an adapter.**

\*Dr. Brown's, Medela, Nuk, EvenFlo, Parent's Choice, Tommee Tippee, Avent, Comotomo, Olababy and Boon Nursh are trademarks of their respective owners.

## BEFORE YOU BEGIN

FOR USE WITH ROOM-TEMPERATURE OR REFRIGERATED LIQUIDS ONLY. FROZEN BREAST MILK MUST BE THAWED BEFORE USING THIS APPLIANCE.

The warmer should not be powered ON without a baby bottle filled with water or breast milk installed on the warmer.

**Warmer may overheat if used improperly.**

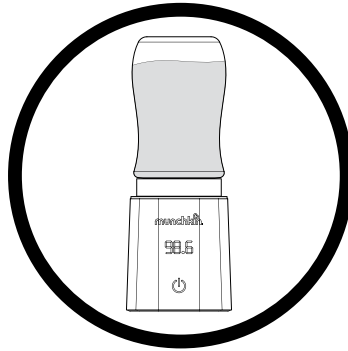
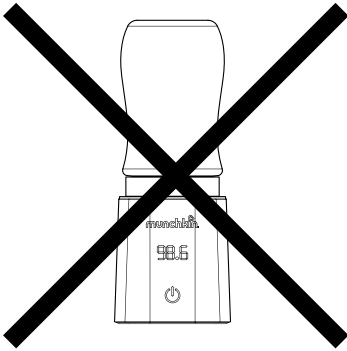

Three dashes “\_ \_ \_” on the front of warmer indicates that the warmer’s heating plate has overheated.

Under this scenario, you must wait 15 minutes before the unit is ready for use.

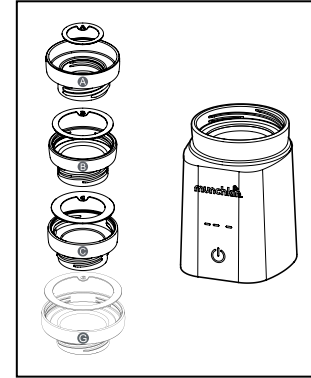
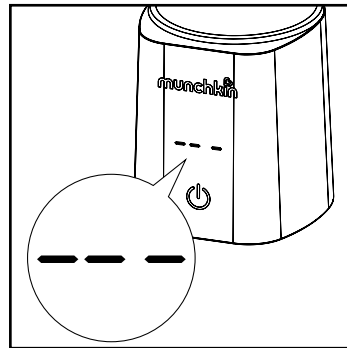

1. Choose the correct adapter for your baby bottle (see Included Adapters on page 7).

Ensure the gaskets are installed in the warming unit and adapter (gasket identification letter facing up).

Screw the adapter into the neck of the warming unit.

If no adapter is needed, proceed to step 2.

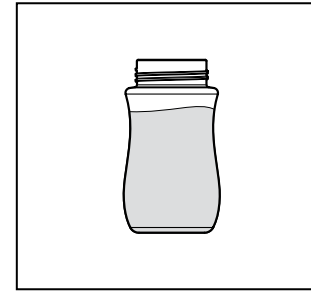

2. Fill the baby bottle with water (for formula) or breast milk.

**NOTE:** Warm water first, then mix in powdered formula once heating cycle is complete.

For best results do not use to heat premixed formulas or alternative milks.

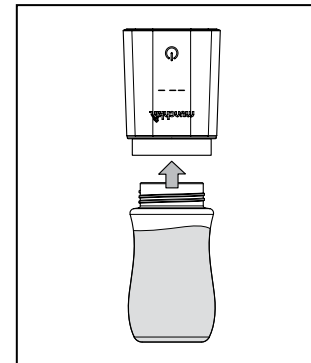

3. **FLIP THE WARMING UNIT UPSIDE DOWN** and screw the baby bottle into the unit or adapter. Twist until the bottle is pressed firmly against the gasket to ensure a watertight seal.

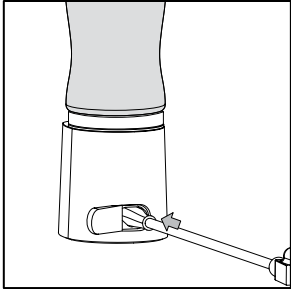

- Open the rubber cover on the back of the warming unit, then insert the power cord. Plug the cord into an electrical outlet.

The standby mode is ready and display will blink 00.0, it will automatically stop after 30 seconds if no action is taken.

**NOTE:** When the warmer turn off after 30 seconds of no action. PRESS AND HOLD the button once for 2 seconds to activate the standby mode. Next PRESS and HOLD again for 2 seconds to activate the heating cycle.

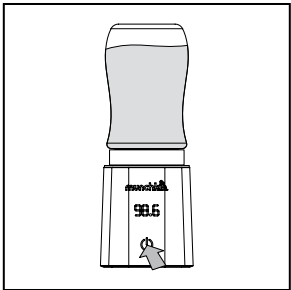

- Make sure the warming unit is right side up when standby mode is ready and then press and hold the power button for **two seconds** to start warming. The digital 98.C display will turn on.

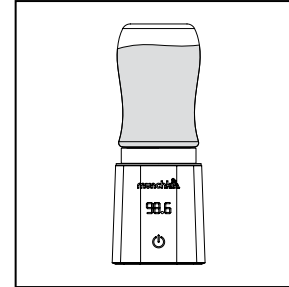

- When the liquid reaches approximately 98.6°F, the warming unit will beep to indicate the cycle is complete. The liquid will be kept at this temperature for up to **15 minutes** after the cycle is complete. After the **15 minutes** the warming unit will auto shut off.

**NOTE:** To ensure your liquid is warmed properly, wait until the end of the warming cycle before removing the bottle.

- When ready to remove the bottle, press and hold the power button for **two seconds** to turn off the unit. Then unplug the cord from the unit and the wall outlet. Flip the device upside down, unscrew the baby bottle and shake the bottle well to ensure proper heat distribution. Always check the liquid's temperature before feeding.

**NOTE:** Warming a second bottle – Allow at least 5 minutes for the unit to cool before next use.

## WARMING TIMES

VOLUME	STARTING MILK TEMPERATURE	
	72°F (22°C)	42°F (5°C)
4oz/120ml	~4 mins	~5.5 mins
6oz/180ml	~5 mins	~7 mins
8oz/240ml	~6.5 mins	~9 mins

**NOTE:** Based on most common standard sized bottles. ~4 mins means “approximately 4 minutes”

The warming durations are to be used as a guide only. Bottle style and size, liquid starting temperature and volume can impact the warming speed and final temperature.

For optimal heating temperature use with 4oz to 8oz of liquid.

**ON/OFF: Press and hold for 2 seconds**

## HOW TO CLEAN

Always unplug unit and ensure that it is cool before cleaning. Do not use scouring pads, abrasives or solvents for cleaning; they may damage the appliance and its surface. Place the rubber plug back into the plug attachment to prevent water intrusion and cause electrical short during cleaning.

**Digital Bottle Warmer:** Wipe all surfaces with a damp cloth or sponge using mild liquid soap, rinse with clear water. Allow to air-dry. Do not submerge unit in liquid.

**Adapters and Gaskets:** Wash with mild liquid soap and rinse with clear water. Allow to air-dry. Always replace gaskets to their proper locations (gasket identification letter facing up).

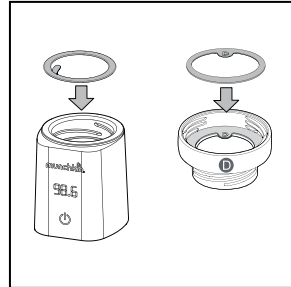

Keep Dust Cover on when not in use to keep heating plate clean.

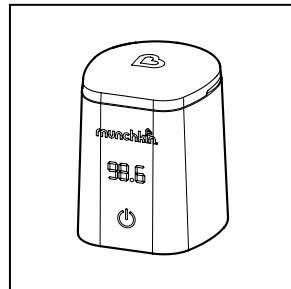

## DE-SCALE

De-scale your bottle warmer after every use to ensure residual deposits are removed from the heating plate and the silicone seal. To de-scale, mix 15ml (0.5oz) of white vinegar with 15ml (0.5oz) of cold water and pour into the heating plate. Allow liquid to stand in the unit until any deposits (limescale) have dissolved. Discard liquid and wipe heating plate with a damp cloth. Repeat process if necessary.

To avoid bacteria growth, perform "Cleaning" and "De-Scaling" after every use.

## TROUBLESHOOTING

**Blinking display:** Digital Bottle Warmer will not operate if tilted more than 30°. Place warmer on a flat and stable surface.

**Overheat protection:** Power switch turns off after three consecutive beeps – circuit protection detects rapid increase in internal temperature to prevent damage to the device.

**Three beeps:** Digital Bottle Warmer will power off due to limescale deposit build up on heating plate or if breast milk has not been mixed thoroughly.

**Display "E1":** Digital Bottle Warmer is not responding to input command from the control panel due to not functioning temperature sensor.

**Display show "E2":** Digital Bottle Warmer is not responding to input command from the control panel due to not functioning heating element.

For "E1" and "E2" errors, please contact our Customer Satisfaction team at **1-800-344-2229** (M-TH 8:00am-5:00pm PST, F 8:00am-1:00pm PST) or visit our website at **[www.munchkin.com](http://www.munchkin.com)**.

## TECHNICAL SPECIFICATIONS

- Product name: 98° Digital Bottle Warmer
- Model: MKFE0769-01

### Electrical Rating:

- Input Voltage: 120VAC, 60Hz
- Wattage: 110W
- Warming unit dimensions: L3.3"(8.3 cm) x W3" (7.6 cm) x H3.4" (8.5 cm)
- Warming unit net weight: 0.4 lb(198g)

- Safety listings:
- CONFORMS TO UL STD. 1026

## ONE-YEAR LIMITED WARRANTY

Munchkin's 98° Digital Bottle Warmer includes a 1-year limited warranty against defects from the date of purchase. In the event of a malfunction or defect during the in-warranty period, Munchkin, Inc. at its option, will replace or repair the product under warranty. Upon receipt of the product and proof of purchase with a valid date of purchase, the defective part will be immediately repaired or replaced and returned to you free of charge (USA only). Please send defective unit, proof of purchase and a description of the problem you have encountered to:

Munchkin, Inc.  
7835 Gloria Avenue  
Van Nuys, CA 91406, USA  
Attn: 98° Digital Bottle Warmer Warranty

**NOTE:** This warranty does not cover misuse, abuse, abnormal wear & tear, negligence, environmental exposure, alteration or accident. Any alteration or removal of the product date code invalidates all claims against the manufacture.

## CONTACT US

If you have any questions or wish to provide comments about this product, feel free to contact our Customer Satisfaction team at **1-800-344-2229** (M-TH 8:00am-5:00pm PST, F 8:00am-1:00pm PST) or visit our website at **[www.munchkin.com](http://www.munchkin.com)**.



**munchkin**<sup>®</sup>  
*it's the little things.*

munchkin.com  
800.344.2229

